

15T 全自動熱室鋅合金壓鑄機

壓力大、速度快、效率高、無切削；
High pressure, Fast speed, High efficiency, No burr
可同時選擇用電或媒介（油）
Power or media (oil) can be selected at the time

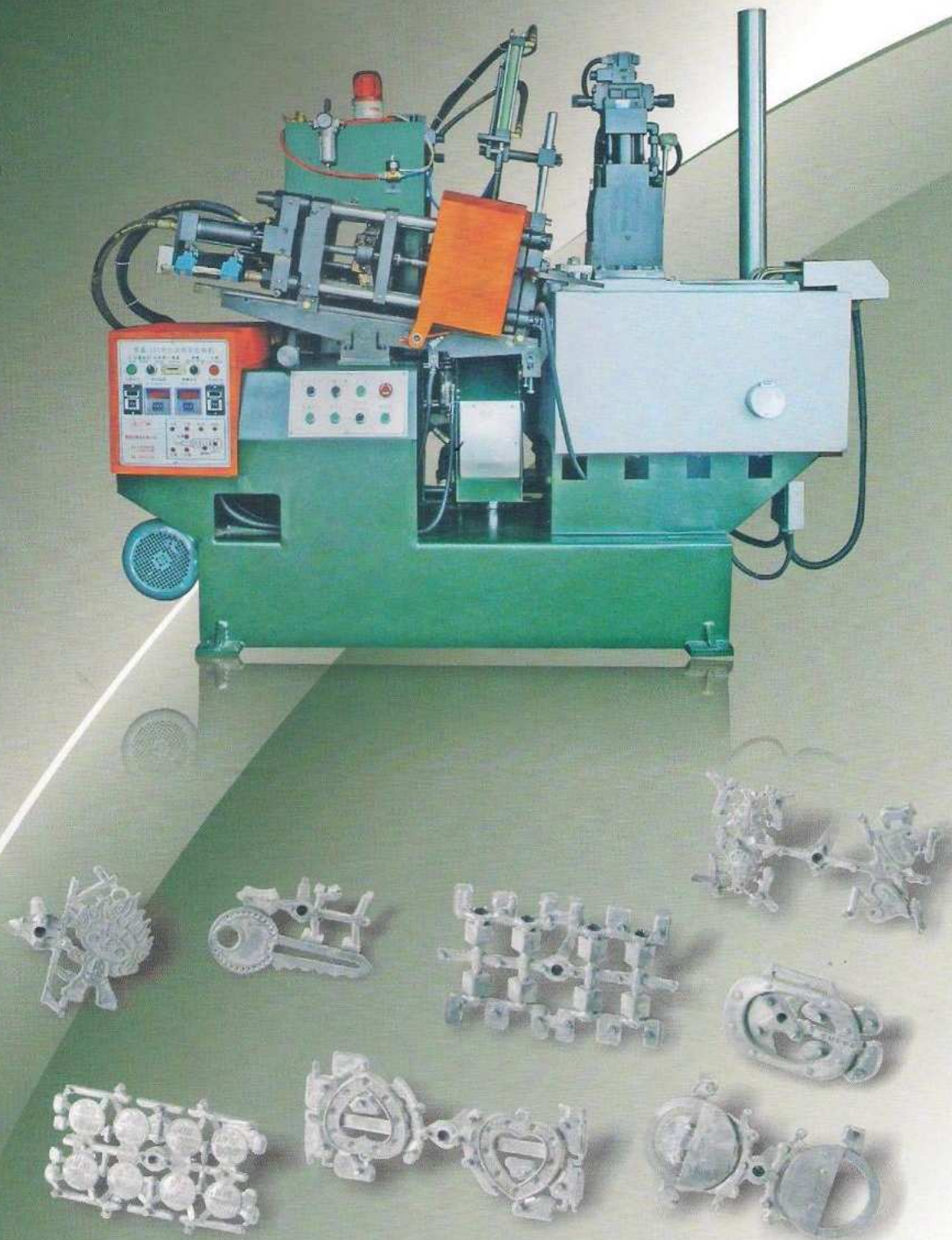



夾具加固：避免因搖動造成斷裂及漏電和短路現象
Jig reinforcement: Avoid break, leakage and short circuit caused by shaking.



全電腦一體化控制,可編程及遠程控制,無須以太網卡;
採用美國H3ORNEA\OCS控制器,中英文顯示;實時控制,
輕鬆采集生產數據
Computer integrated control, programmable and remote control, no Ethernet card; Using the United States H3ORNEA \ OCS controller, displaying Chinese or English; Real-time control, easy to collect production data



氮氣瓶座連體型：避免傳統機器管接式因壓射震動產生的震裂漏油現象
Combined Nitrogen gas cylinder seat: Avoid oil leaking accidents of shatter crack caused by injection vibration from pipe coupling design of the traditional machine.



進退座油缸式：解決進退座的煩累，更加方便快捷
Seat in and Seat out cylinder: Easy and fast on cylinder forward and backward.



安全門開關：避免因疏忽或生產操作出現故障
Safety cover switch: Avoid operation faults caused by carelessness.

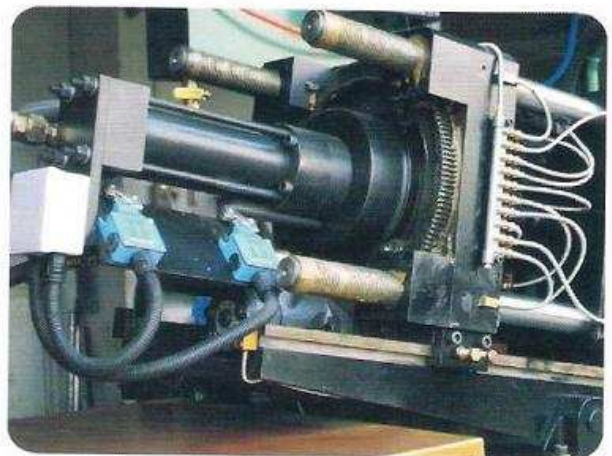

液壓調模：模具的厚薄通過液壓泵調節，精，準。
Hydraulic mold adjustment: Adjust the thickness of mold through hydraulic pump, precious and accurate.



壓射軟管式：避免傳統無縫管焊接式因壓射產生的漏油現象、確保壓射的平穩
Injection hose: Avoid oil leaking accidents caused by injection from welded seamless tube design of traditional machine.



大容量離型劑罐：避免以前小容量頻繁添加脫模劑的繁瑣
Large capacity mold release tank: Avoid frequent mold release agent adding trouble with small capacity tank,



微電腦自動熔料：可在停機後隨意設定以後的熔料時間
Microcomputer automatic melting: Can set the material melting time freely after machine stopped working.



開模合模開關採用三段自動復位式避免傳統二段式造成的開合模線圈經常燒壞的弊病，採用德國西門子產品
Mould open and Mould close switch adopts 3-level automatic reset switch design, avoid mould open & close coils burnout problem with traditional 2-level switch, adopts Siemens products imported from Germany.

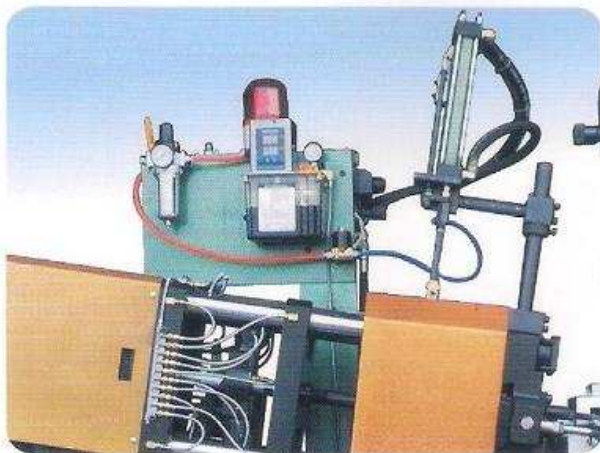

全自動潤滑系統
Automatic Lubrication System



特設卸壓裝置，可有效保護油泵及電機，延長其使用壽命。
Special pressure relief device, can protect oil cylinder and electric motor effectively and extend service life.

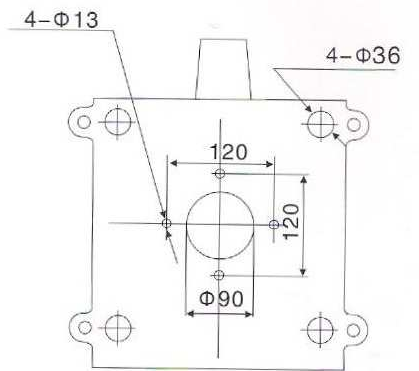
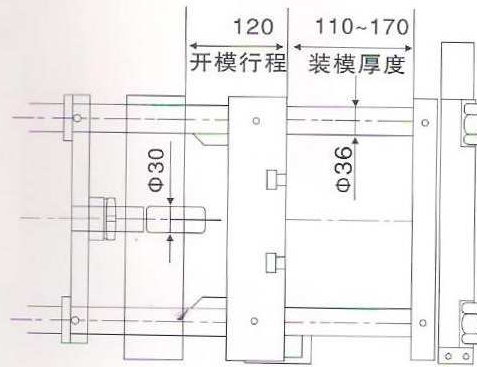
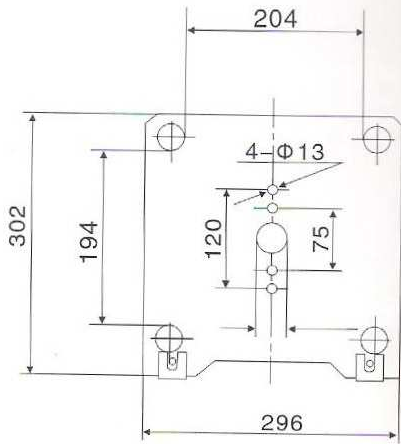
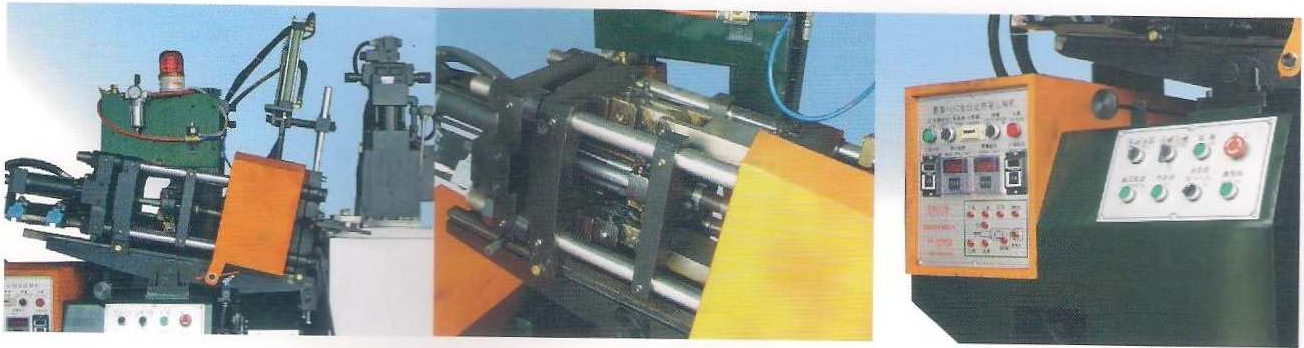

项目 Unit	单位 Specification	参数 Item	项目 Unit	单位 Specification	参数 Item
合模力 Clamping Force	kN	150	鋅鍋容量 Volume of Crucible(Zinc)	kg	65
合模油缸缸徑 Diameter of Di-Cylinder	mm	50	油泵流量 Oil Pump Flow	L/min	26
拉杆直径 Tie Bar Diameter	mm	36	蓄能器容量 Accumulator Volume	L	6.3
开模行程 Opening Stroke	mm	120	油箱容量 Oil Tank Volume	L	150
拉杆内间距(高X宽) Space between Tie Bars(H*W)	mm	194~204	空循环时间 Dry Cycle Time	s	3
模具厚度范围 Die Thickness(Min.~Max.)	mm	110~170	喷嘴电加热功率 Heating Power Of Spray Nozzle	kW	1
射料缸行程 Stroke of Injection Cylinder	mm	50	熔料电加热功率 Heating Power for Material Melt	kW	9~12
射料柱塞直径 Diameter of Injection Plunger	mm	35	熔料燃油用量 Fuel Oil Use for Material Melt	kg/h	1.5
射出力 Injection Force	kN	16	电机功率 Motor Power	kW	5.5
压射油缸缸徑 Diameter of Injection Plunger	mm	60	工作油压力 Hydraulic Pressure	Mpa	5~7
有效射出量 Effective Shot Weight	g	100~200	机器外形尺寸 Overall Dimensions	mm	2400x850x1800
扫落行程 Traverse Stroke	mm	200	机器重量 Machine Weight	t	1.2

Note:For more details on product,please call us directly.